

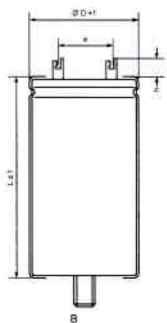

Typ : LFBE22235050076

RoHS conform



Ø D : 50 mm

L : 76 mm

a : 20 mm

h : 10 mm

B M12

Terminals : LF

Electrical Parameters

Rated Capacitance (C_R) 100 Hz / 20 °C	2200 μ F	
Tolerance	± 10 %	
Rated Voltage (U_R)	350 V	
Surge Voltage (U_S) max. 5 x 1 min / h	385 V	
Reverse Voltage (U_U) max. 1 s	2 V	
Leakage Current (I_L) U_R / 5 min / 20 °C	4600 μ A	
ESR typ. 100 Hz / 20°C	43 m Ω	
Tan δ typ. 100 Hz / 20°C	6 %	
Z max. 10 kHz / 20°C	64 m Ω	
ESL typ.	20 nH	
Rated Ripple Current (I_R) 100 Hz / 85°C	4 A	
Useful Life @ i_{R_r} , U_{R_r} , 85°C	4000 h	
IEC Climatic category/ Standards	40/085/56	IEC 60384-4
Applications	Photo flash	
Your article No. / Project		