

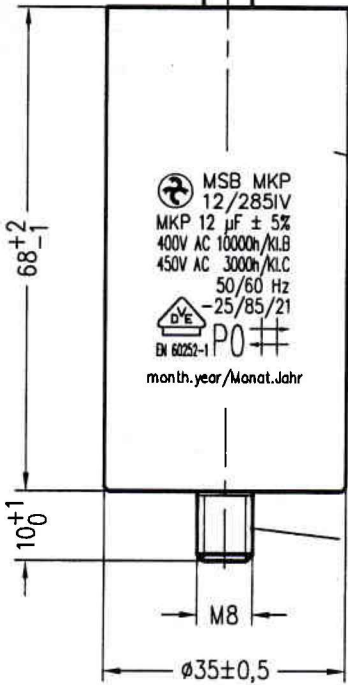

terminal ends
Aderendhülsen

cable
H05V2V2-F 2x 0,75 mm²
Schlauchleitung
H05V2V2-F 2x 0,75 mm²

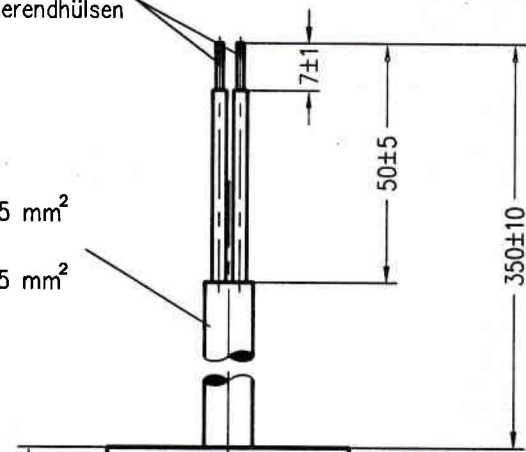

 MSB MKP
 12/285IV
 MKP 12 µF ± 5%
 400V AC 10000h/KLB
 450V AC 3000h/KLC
 50/60 Hz
 -25/85/21
 EN 60252-1 P0
 month.year/Monat.Jahr

plastic case
Kunststoffgehäuse

locking washer to AEG Drawing 464.087 490.EZ
hexagon nut ISO 4035-M8-04-A3J
free added

Zahnscheibe nach AEG Zeichnung 464.087 490.EZ
Sechskantmutter ISO 4035-M8-04-A3J
lose mitgeliefert

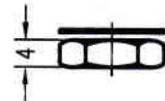

cast compound
Verguß

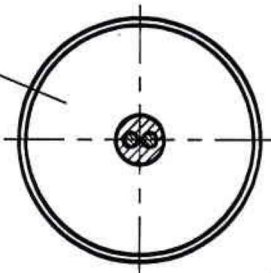

marking in black colour
Beschriftung in schwarzer Farbe

Masstab: 1:1

Werkstoff:

MKP-capacitor
MSB MKP 12/285IV/E1373